

# GEORGIA MOTOR VEHICLE CRASH REPORT OVERLAY



ALCOHOL AND/OR DRUG TEST GIVEN
1-Yes
2-No
3-Refused

TEST TYPE
1-Blood
2-Breath
3-Urine
4-Other

FIRST / MOST HARMFUL EVENT
<i>Non Collision</i>
1-Overturn
2-Fire/Explosion
3-Immersion
4-Jackknife
5-Other Non-Collision
35-Cargo/Equipment Loss or Shift
<i>Collision With Object Not Fixed</i>
6-Pedestrian
7-Pedalcycle
8-Railway Train/Street Car
9-Animal
10-Parked Motor Vehicle
11-Motor Vehicle in Motion
13-Other Object (Not Fixed)
14-Deer
36-Work Zone/Maintenance Equipment
<i>Collision With Fixed Object</i>
15-Impact Attenuate
16-Bridge Pier/Abutment
17-Bridge Parapet End
18-Bridge Rail
19-Guardrail Face
20-Guardrail End
21-Median Barrier
22-Highway Traffic Sign Post
23-Overhead Sign Support
24-Luminaire Light Support
25-Utility Pole
26-Other Post
27-Culvert
28-Curb
29-Ditch
30-Embankment
31-Fence
32-Mailbox
33-Tree
34-Other-Fixed Object
37-Bridge Overhead Structure
38-Cable Barrier

OPERATOR/PEDESTRIAN CONDITION
1-Not Drinking
2-Unknown
4-U.I. Alcohol
5-U.I. Drugs
6-U.I. Alcohol & Drugs
7-Physical Impairment
8-Suspected Fatigued or Asleep
9-Emotional (depressed, angry, disturbed, etc.)
10-Suspected U.I. (Alcohol and/or Drugs)

OPERATOR CONTRIBUTING FACTORS
1-No Contributing Factors
2-Under the Influence (U.I.)
3-Following Too Close
4-Failed to Yield
5-Exceeding Speed Limit
6-Disregard Stop Sign/Signal
7-Wrong Side of Road
9-Improper Passing
10-Driver Lost Control
11-Changed Lanes Improperly
12-Reaction to Object or Animal
13-Improper Turn
14-Parked Improperly
17-Misjudged Clearance
18-Improper Backing
19-No Signal/Improper Signal
20-Driver Condition
22-Too Fast for Conditions
23-Improper Passing of School Bus
24-Disregard Police - Traffic Control
26-Other
28-Inattentive or Other Distraction (Distracted)
29-Texting (Distracted)
30-Talking on Hands-Free Device (Distracted)
31-Talking on Hand-Held Device (Distracted)
32-Other Activity-Mobile Device (Distracted)
33-Occupant Distraction (Distracted)
34-Other Interior Distraction (Distracted)
35-Other Exterior Distraction (Distracted)
36-Disregard Other Traffic Control
37-Reckless Driving
38-Aggressive Driving
39-Racing
40-Disregard Police - Evasion
41-Not Visible (Object, Person, or Vehicle)
42-Vision Obscured

VEHICLE CONTRIBUTING FACTORS
1-No Contributing Factors
2-Tire Failure
3-Brake Failure
4-Improper or Inoperative Lights/Signals
5-Steering Failure
6-Slick Tires
7-Other
8-Mirrors
9-Power Train
10-Suspension
11-Truck Coupling/Trailer Hitch/Safety Chains
12-Windows/Windshield
13-Wipers

ROADWAY CONTRIBUTING FACTORS
1-No Contributing Factors
2-Shoulder (none, low, soft, high)
3-Ruts, Holes, Bumps
4-Loose Material On Surface
5-Water Standing
6-Work Zone (construction/maintenance/utility)
7-Running Water
8-Other
9-Backup Due to Prior Crash/Secondary Crash
10-Traffic Congestion
11-Road Surface Condition (wet, icy, snow, slush, etc.)
12-Obstruction in Roadway
13-Visual Obstruction(s) - Other Along Roadway
14-Visual Obstruction(s) - Vegetation Along Roadway
15-Incident Response Scene

DIRECTION OF TRAVEL
1-North
2-South
3-East
4-West

VEHICLE MANEUVER
1-Turning Left
2-Turning Right
3-Making U-Turn
4-Stopped
5-Straight
6-Changing Lanes
7-Backing
8-Parked
9-Passing
10-Negotiating a Curve
11-Entering/Leaving Parking
12-Entering/Leaving Driveway
13-PIT
14-Other

NON-MOTORIST MANEUVER
1-Crossing, Not at Crosswalk
2-Crossing at Crosswalk
3-Moving With Traffic on Roadway
4-Moving Against Traffic on Roadway
5-Pushing or Working on Vehicle
6-Other Working in Roadway
7-Playing in Roadway
8-Standing in Roadway
9-Off Roadway
10-Other
11-Darting Into Traffic
12-Entering/Exiting Bus
13-Entering/Exiting Parked or Standing Vehicle

VEHICLE CLASS
1-Privately Owned
2-Police
3-Fire
4-School
5-Other Govt. Owned
6-Military
7-Commercial Motor Vehicle (CMV)
8-Other
9-Non-Transport Emergency Services Vehicle/HERO
10-Passenger Service Vehicle (Taxi)

VEHICLE TYPE
1-Passenger Car
2-Pickup Truck
3-Truck Tractor (Bobtail)
4-Tractor/Trailer
5-Tractor W/Twin Trailers
6-Logging Truck
7-Logging Tractor/Trailer
8-Single Unit Truck
9-Panel Truck
10-Van
11-Sports Utility Vehicle (SUV)
12-Vehicle With Trailer
13-Bus
14-Truck Towing House Trailer
15-Ambulance
16-Motorized Recreational Vehicle
17-Motorcycle
18-Moded, Scooter, or Minibike
19-Pedalcycle or Bicycle
20-Farm or Construction Equip.
21-All Terrain Vehicle (ATV)
22-Other
23-Golf Cart or Go Cart

VISION OBSCURED BY
1-Not Obscured
2-Headlights
3-Sunlight/Glare
4-Parked/Stopped Vehicle
5-Trees, Bushes
6-Rain, Snow, Ice on Windshield
7-Other

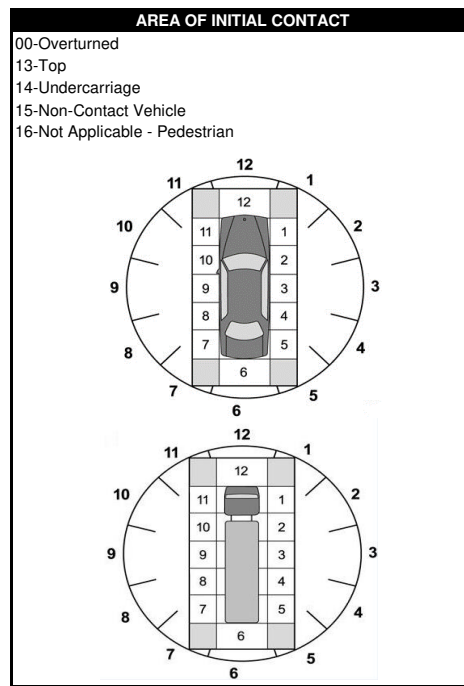

DAMAGE TO VEHICLE
1-No Damage
2-Minor Damage
3-Functional Damage
4-Disabling Damage

TRAFFIC-WAY FLOW
1-Two-way Traffic-way With No Physical Separation
2-Two-way Traffic-way With a Physical Separation
3-Two-way Traffic-way With a Physical Barrier
4-One-way Traffic-way
5-Continuous Turning Lane

ROAD COMPOSITION
1-Concrete
2-Black Top
3-Tar and Gravel
4-Dirt
5-Gravel
6-Other

ROAD CHARACTER
1-Straight and Level
2-Straight on Grade
3-Straight on Hillcrest
4-Curve and Level
5-Curve on Grade
6-Curve on Hillcrest

WORK ZONE
0-None
1-Construction
2-Maintenance
3-Utility
4-Unknown Type

TRAFFIC CONTROL
0-Gate
1-No Control Present
2-Traffic Signal
3-RR Signal/Sign
4-Warning Sign
5-Stop Sign
6-No Passing Zone
7-Lanes
8-Other
9-Flashing Lights
10-Yield Sign

CARGO BODY TYPE
1-Van (Encl. Box)
2-Auto Carrier or Tow Truck
3-Bus
4-Dump
5-Garbage/Refuse
6-Flatbed
7-Cargo Tanker
8-Concrete Mixer
9-Other
10-Hopper
11-Intermodal Container Chassis
12-Pole-Trailer

VEHICLE CONFIGURATION
1-Bus (Seating for More Than 15 Passengers)
2-Single Unit Truck: 2 Axles
3-Single Unit Truck: 3 or More Axles
4-Truck Trailer
5-Truck Tractor (Bobtail)
6-Tractor Trailer
7-Tractor With Twin Trailers
8-Unknown Heavy Truck (Cannot Classify)
9-Bus/Large Van (seats for 9-15 occupants, including driver)
10-Vehicle 10,000 Pounds or Less Placarded for Hazardous Materials

PAGE 2 ATTRIBUTES (SHADED)
MANNER OF COLLISION
1-Angle
2-Head On
3-Rear End
4-Sideswipe - Same Direction
5-Sideswipe - Opposite Direction
6-Not a Collision With a Motor Vehicle

LOCATION AT AREA OF IMPACT
1-On Roadway - Non-Intersection
2-On Shoulder
3-Off Roadway
4-Median
5-Entrance/Exit Ramp
6-Gore
7-On Roadway - Roadway Intersection
8-On Roadway - Roundabout
9-On Roadway - Driveway Intersection
10-On Roadway - Railroad Crossing
11-On Roadway - Managed Lane (HOV, HOT, Reversible)
12-On Roadway - Collector Distributor (CD)
13-On Roadway - Bicycle Lane
14-On Roadway - In Crosswalk
15-Off Roadway - Sidewalk
16-Private Property

WEATHER
1-Clear
2-Cloudy
3-Rain
4-Snow
5-Sleet
6-Fog
7-Other
8-Severe Thunderstorm or Tornadoic

SURFACE CONDITION
1-Dry
2-Wet
3-Snow
4-Ice/Frost
5-Other
6-Mud
7-Sand
8-Slush
9-Oil
10-Water (standing or moving)

LIGHT CONDITION
1-Daylight
2-Dusk
3-Dawn
4-Dark - Lighted
5-Dark - Not Lighted

AGE
00-Up to One Year
01 to 97-Actual Age
98-Ninety-eight years old or Older
99-Unknown

SEX	
M-Male	F-Female

SEATING POSITION
1-Front Seat - Left Side (Operator)
2-Front Seat - Middle
3-Front Seat - Right Side
4-Rear Seat - Left Side
5-Rear Seat - Middle
6-Rear Seat - Right Side
7-Other Seat - Interior
8-Riding on Vehicle Exterior
9-Non-Motorist - Outside of a Vehicle

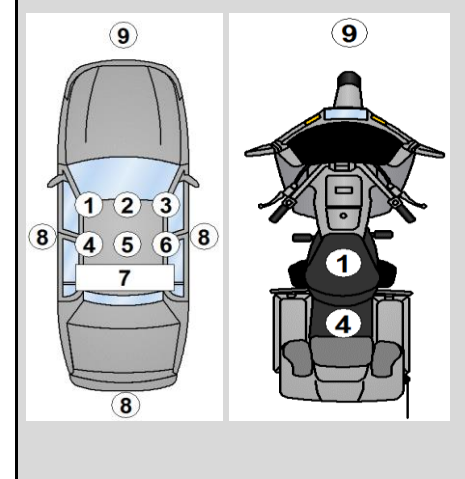

SAFETY EQUIPMENT
0-None Used
1-Shoulder Belt Only Used
2-Lap Belt Only Used
3-Lap and Shoulder Belt Used
4-Child Restraint System (Properly Used)
5-Child Restraint System (Improperly Used)
6-Motorcycle Helmet
7-Bicycle Helmet
8-Unknown
9-Booster Seat (Properly Used)
10-Booster Seat (Improperly Used)
11-Non-Motorist Lighting
12-Reflective: Clothing/Backpack/Equipment

EJECTION
1-Not Ejected
2-Trapped
3-Totally Ejected
4-Partially Ejected
5-Not Applicable

EXTRICATION (Equipment Used)
1-Yes
2-No

AIR BAG FUNCTION
0-No Air Bag in this Seat
1-Deployed Air Bag
2-Non-Deployed Air Bag
3-Deployed Side
4-Deployed other Directions
5-Deployed Multiple Directions
6-Non-Deployed Front
7-Non-Deployed Side
8-Non-Deployed Other Direction
9-Non-Deployed Multiple Directions
10-Deployed Curtain

INJURY
0-No Apparent Injury (O)
1-Fatal Injury (K)
2-Suspected Serious Injury (A)
3-Suspected Minor or Visible Injury (B)
4-Possible Injury or Complaint (C)

TAKEN FOR TREATMENT
1-Yes
2-No